

Delivering leading edge, innovative power solutions for more than 30 years....

Model:GTM41134-WVVV-F

June 24, 2019

GTM41134-WVVV-F

Information

Model Number GTM41134-WVVV-F

Description GTM41134-WVVV-F, Medical Power Supply, 60601-1-4th Ed. , Open Frame/Internal, Regulated Switchmode AC-DC Power Supply AC Adaptor, , Input Rating: 100-240V~, 50-60 Hz, Molex 09-65-2058 3 Position Header Pin 1: Line, Pin 2: Removed, PIN 3: Neutral, Pin 4: removed, Pin 5: Earth, Output Rating: 6 Watts, Power rating with convection cooling (W) , 3.3-48V in 0.1V increments, Approvals: LPS; CE; EAC; WEEE; VCCI; China RoHS; RoHS; Ukraine; Book 60601; CB 60601-1 2MOPP; PSE; Level V; RCM;

Model Picture

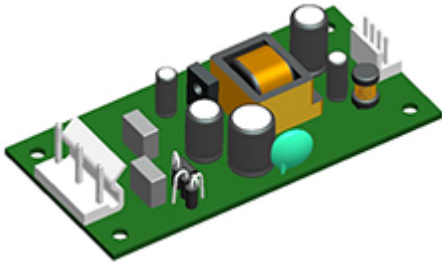

Agency Documents <http://www.globtek.info/certs/GTM41134/>

CE EC-Declaration https://www.globtek.com/pdf/ec_declaration/a00a000000MEXnlEAH

RoHS/RoHS2 Declaration https://www.globtek.com/pdf/rohs_cert/a00a000000MEXnlEAH

REACH Declaration https://www.globtek.com/pdf/iso_certificates/REACH.pdf

Conflict Minerals Declaration <https://www.globtek.com/pdf/conflict-minerals.pdf>

Delivering leading edge, innovative power solutions for more than **30** years....

Model:GTM41134-WVV-F

June 24, 2019

Model Parameters

Type	Open Frame/Internal
Technology	Regulated Switchmode AC-DC Power Supply AC Adaptor
Category	Medical Power Supply
Input Voltage	100-240V~, 50-60 Hz
I/P Amps (A)	0.6A Max
Wattage (W)	6.0
Vout Range (V)	3.3-48
Efficiency Level	N/A
Ingress Protection	
Size (mm)	84.5*41.5*17.0

Delivering leading edge, innovative power solutions for more than 30 years....

Model:GTM41134-WVV-F

June 24, 2019

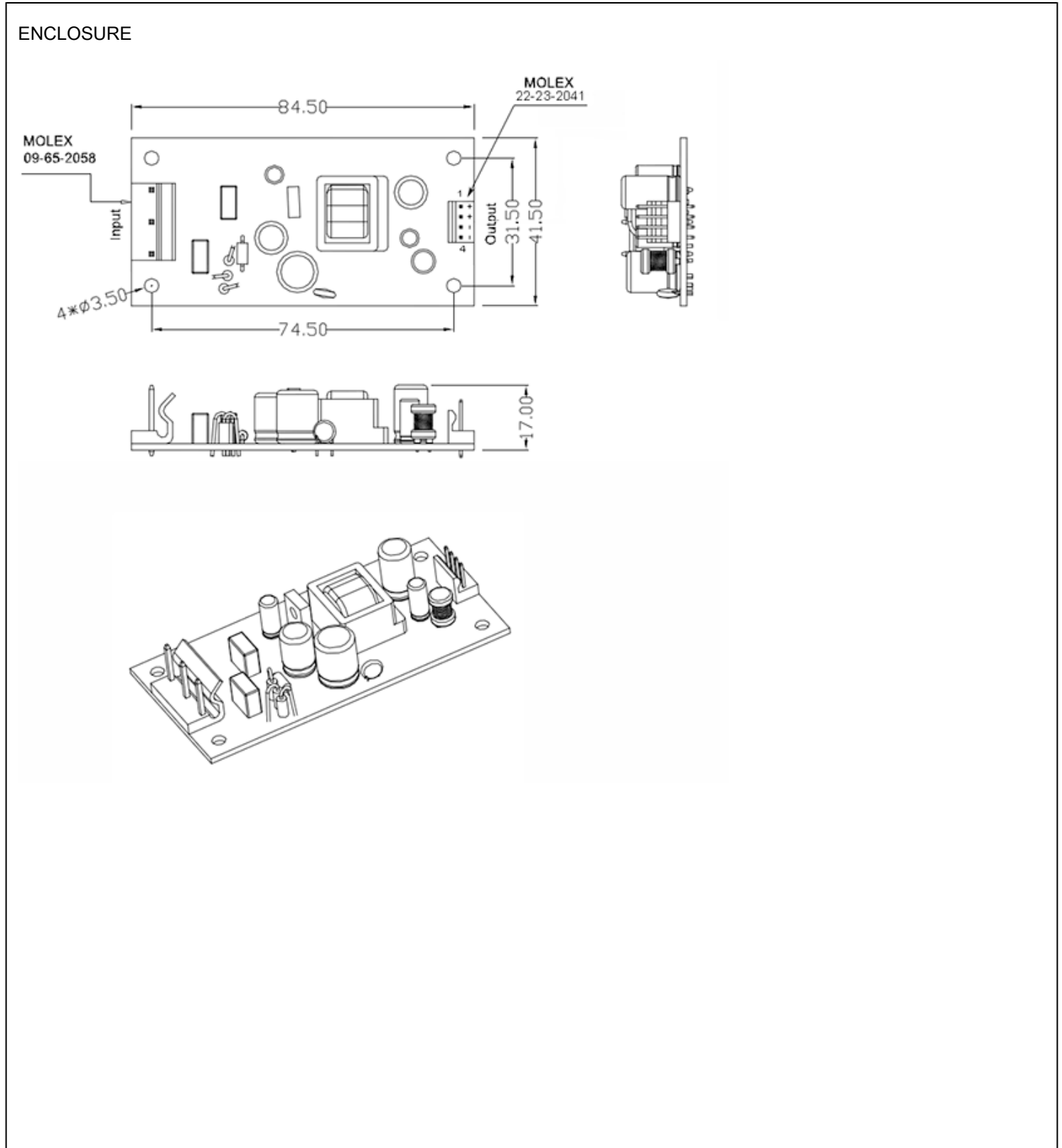

PROPRIETARY INFORMATION

PROPRIETARY OF GLOBTEK, INC. ANY REPRODUCTION, DISCLOSURE OR USE OF THIS DRAWING, IN WHOLE OR IN PART, IS HEREBY PROHIBITED EXCEPT AS SPECIFIED IN WRITING BY GLOBTEK, INC.

<http://en.globtek.com/datasheet/id/a00a000000MEXnl>

Delivering leading edge, innovative power solutions for more than **30** years....

Model:GTM41134-WVV-F

June 24, 2019

RATING TABLE

Model Number	Voltage	Amps(A)	Watts(W)	RFQ
GTM41134-0603-F	3.3 V	1.8	5.94	RFQ
GTM41134-0606-1.0-F5 V	1.2	6.00	RFQ	
GTM41134-0606-F	6 V	1	6.00	RFQ
GTM41134-0612-5.0-F7 V	0.85	5.95	RFQ	
GTM41134-0612-3.0-F9 V	0.66	5.94	RFQ	
GTM41134-0612-F	12 V	0.5	6.00	RFQ
GTM41134-0615-F	15 V	0.4	6.00	RFQ
GTM41134-0618-2.0-F16 V	0.375	6.00	RFQ	
GTM41134-0618-F	18 V	0.33	5.94	RFQ
GTM41134-0624-5.0-F19 V	0.31	5.89	RFQ	
GTM41134-0624-4.0-F20 V	0.3	6.00	RFQ	
GTM41134-0624-F	24 V	0.25	6.00	RFQ
GTM41134-0636-2.5-F33.5 V	0.179	6.00	RFQ	
GTM41134-0636-F	36 V	0.16	5.76	RFQ
GTM41134-0648-F	48 V	0.125	6.00	RFQ

Delivering leading edge, innovative power solutions for more than 30 years....

Model:GTM41134-WVV-F

June 24, 2019

SPECIFICATIONS

A) ELECTRICAL SPECIFICATIONS:

01. Input Voltage: Specified 90-264 Vac, Nameplate rated: 100-240Vac
02. Input Frequency: Specified 47-63 Hz, Nameplate rated 50-60Hz
03. Output Current: Current limited to rated output current with tolerance of +/-10%
04. Output Regulation: +/- 5% measured at the output connector
05. Line Voltage Regulation: +/- 1% typical measures at full load
06. Output Ripple (Vp-p): 1% or 150 mV whichever is greater measured at 20 MHz bandwidth with 0.1 uf ceramic capacitor in parallel with 10 uf electrolytic capacitor connected at the end of output connector at nominal line
07. Turn-On/Turn-Off Overshoot: 5% maximum, 1mS typical recovery time for 25% step load
08. Turn-On Delay: 1 second typical
09. Hold-Up Time: 8mS typical @ nominal input voltage & full load
10. Inrush Current: 30A typical @ 115Vac input ; 60A typical @ 230Vac input
11. Switching Frequency: 65 KHz typical

B) PROTECTION

1. Over-Voltage: Unit will recover upon removal of fault
2. Short Circuit: Electronically Protected, unit will recover upon removal of fault
3. Input Protection: Input line fusing

C) SAFETY

1. Dielectric Withstand Voltage: Input-Output: 5656Vdc, (2 MOPP)
2. Earth Leakage Current: N/A for Class II units, there is no PE Ground pin, so Earth Leakage current is not measured
3. Touch Current: Maximum allowed values: 100uA NC(Normal condition) 500uA SFC(single fault condition)
4. Means of Protection: 2 x MOPP
5. Primary to Secondary Bridging Capacitor: Standard configuration provided without bridging capacitors, Two (2) * Y1 type capacitors in series is available as an option upon customer request. If option employed, it is to be noted in the product deviation section of this specification document.

D) OTHER:

1. MTBF: 200,000 hours @ 25°C ambient temperature
 2. Operating Temperature: 0°C to 40°C ambient temperature
 3. Humidity: 0% to 95% relative humidity (RFP RFI-33542-1)
 4. Storage Temperature: -20°C to 80°C
- Normal performance after 2h recovery time at the room temperature without connection to mains (RFP RFI-33542-1)

E) ENCLOSURE

1. Upper Housing: High impact plastic, 94V0 polycarbonate, non-vented
2. Lower Housing: High impact plastic, 94V0 polycarbonate, non-vented
3. Size: 43.5 x 74.0 x 35.3mm +/- 1.0

Delivering leading edge, innovative power solutions for more than **30** years....

Model:GTM41134-WVV-F

June 24, 2019

DERATING CURVE

Delivering leading edge, innovative power solutions for more than 30 years....

Model:GTM41134-WVVV-F

June 24, 2019

Input Configuration

Description Molex 09-65-2058 3 Position Header Pin 1: Line, Pin 2: Removed, PIN 3: Neutral, Pin 4: removed, Pin 5: Earth

Document: http://www.molex.com/pdm_docs/sd/009652058_sd.pdf

Catalog Page: http://www.molex.com/molex/products/datasheet.jsp?part=active/0009652058_PCB_HEADERS.xml

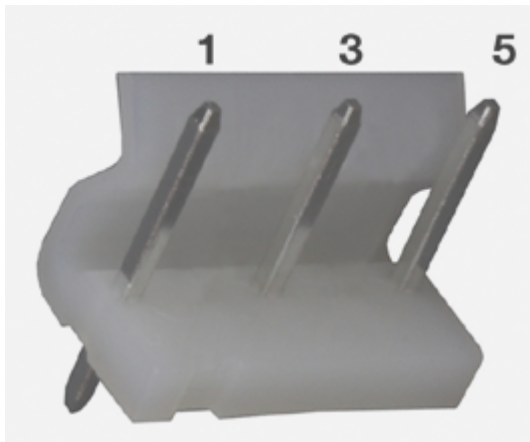
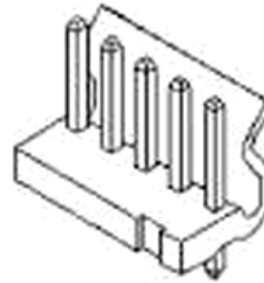
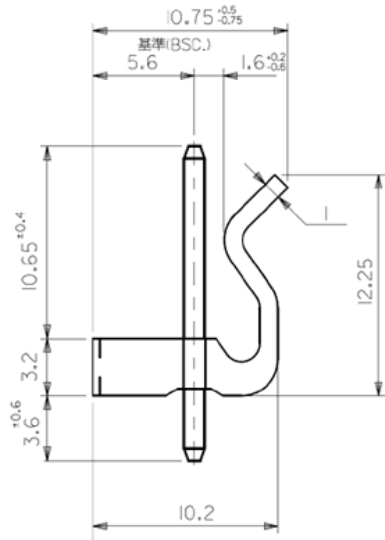

Mates With Part(s):











5195 SPOX™ Crimp Housing, **5239** KK® Crimp Housing

Delivering leading edge, innovative power solutions for more than 30 years....

Model:GTM41134-WVVV-F

June 24, 2019

Approvals

Logo	Description
	60601-1 3rd Operating Instructions
No Logo Applicable	CB report IEC60601-1 2005 A1+C1+C2 2016-2-4 and or EN 60601-1:2006 3.1rd Edition 2xMOPP CE Certification
	CE Mark: tested to comply with EN 55032.2012+AC.2013 EN 61000-3-2.2014 EN 61000-3-3.2013 EN 60601-1-2.2015 EN 55024.2010
	CHINA SJ/T 11364-2014, China RoHS Chart: http://en.globtek.com/globtek-rohs.php
	Certification # TC RU AR46.B.72092 Custom Union of Russia, Belarus and Kazakhstan for GT(M)41134
	Indoor Use Only - Mark is on the label or Molded in the case
EFFICIENCY LEVEL 	Efficiency: complies to section 301 of Energy Independence and Security Act (EISA) complies with Energy Star tier 2 (North America), ECP tier 2 (China), MEPS tier 2 (Australia), Code of Conduct (Europe)
LPS	Limited Power Source
 GlobTek, Inc.	JAPAN TUV Rheinland-PSE GlobTek Inc to J60950-1(H26) , J55022(H22),J3000(H25).Please follow the procedure listed in the following link for proper import to Japan: http://en.globtek.com/importing-to-japan.php .
 N136 SAA-152514-EA	RCM certificate SAA-152514-EA; Australia and New Zealand Regulatory Compliance, Mark (http://rcm.standards.org.au/rcmfaq/rcmfaq.htm)
RoHS	Specifications of directive 2011/65/EU Annex VI (ROHS-2) with amendment 2015/863-EU (ROHS-3) http://www.ce-mark.com/Rohs%20final.pdf
 10276	Ukraine UKRSepro (Document: www.globtek.com/html/iso_certificates/GT_Ukraine.pdf)
	Japan: Voluntary Control Council for Interference (VCCI)
	WEEE: Complies with EU 2012/19/EU (http://ec.europa.eu/environment/waste/weee/index_en.htm) Mark is on the label or Molded in the case